

REHSR

Stainless Steel Round Header



Quality Door Hinge tested by:-



PSB Singapore
50,000 Cycles
Endurance Test

Grade A Tempered Glass Certified by:-



ANSI Z97:1-2004



Cert No:
BMP555249



Cert No:
BMP552817



Product Specification

- Surface Finishes : Glossy Polish/Matt
- Material : Brass Chrome or SUS304 Stainless Steel
- Test : PSB Test Singapore Certified (50,000 Cycles)
- Function : Pivot Door (Inward/outward/bothway)
- Glass : 6mm to 10mm Thickness Tempered ASTM C 1048, ANSI 97.1, BS 6206,

REH100

Wall to Glass
Swing Door Shower



| Door Space Allocation |

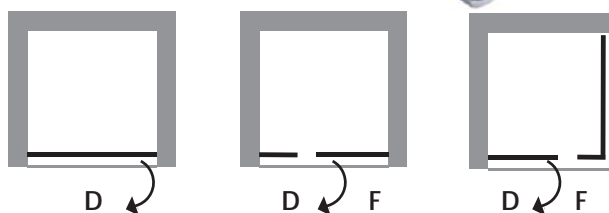

INSTALLATION MANUAL

REH100SR Series

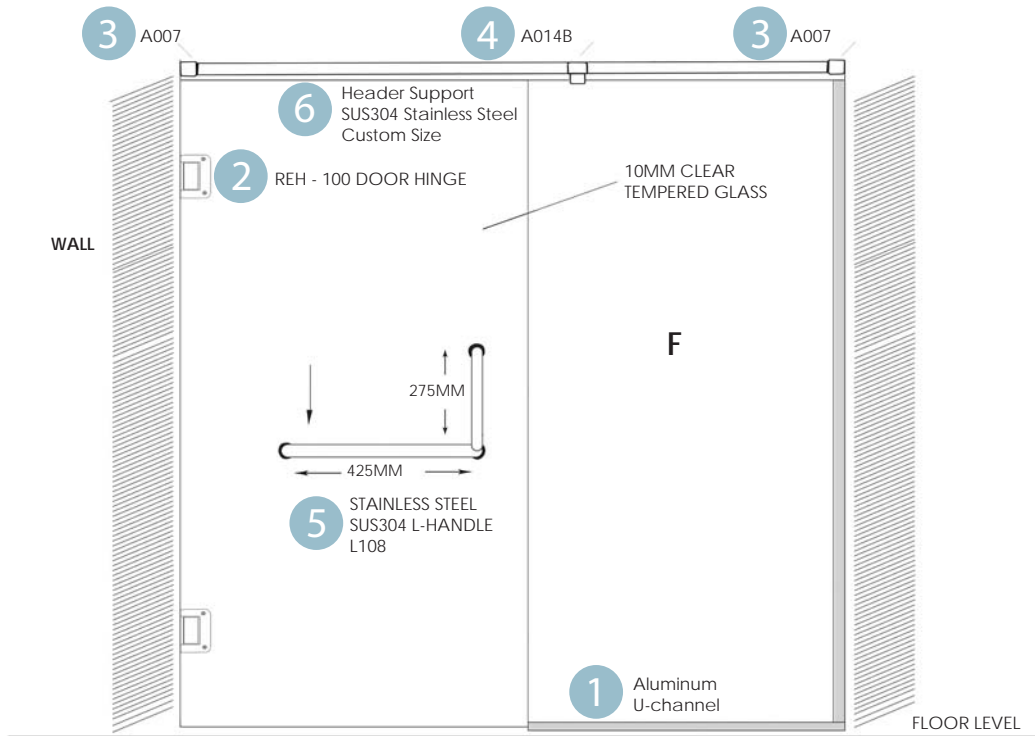

FRONT VIEW

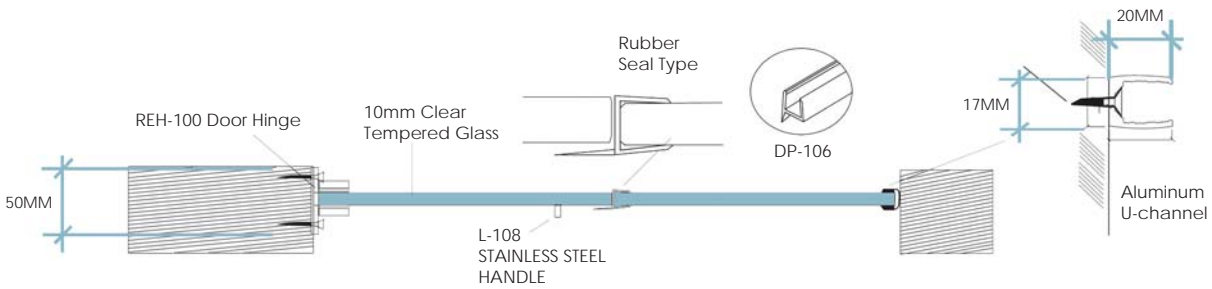

TOP VIEW

Accessories List:-

- | | | |
|--|---|---|
| 
1 Aluminum U-Channel
Glossy Polished | 
2 REH100 Hinge
Brass Chromed | 
3 A007 - Header Holder
SUS304 Stainless Steel |
| 
4 A014B Stainless Steel Bar Holder
SUS304 Stainless Steel | 
5 L-108 Handle
SUS304 Stainless Steel
Size: 275mm x 425mm | 
6 Header Support
SUS304 Stainless Steel
Custom Size |

CUSTOMER PHOTO GALLERY

