

SKYLIGHT

- + Glass Awning
- + Glass Roof
- + Glass Car Porch

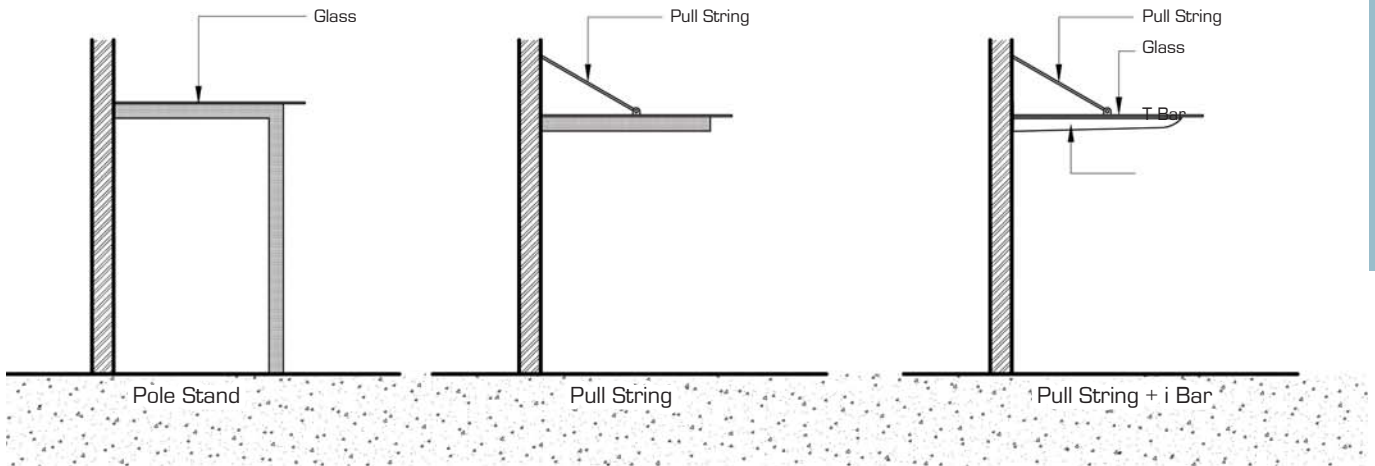

GLASS SUPPORT DESIGN



Hollow Louvres Type 2" x 4" Additional

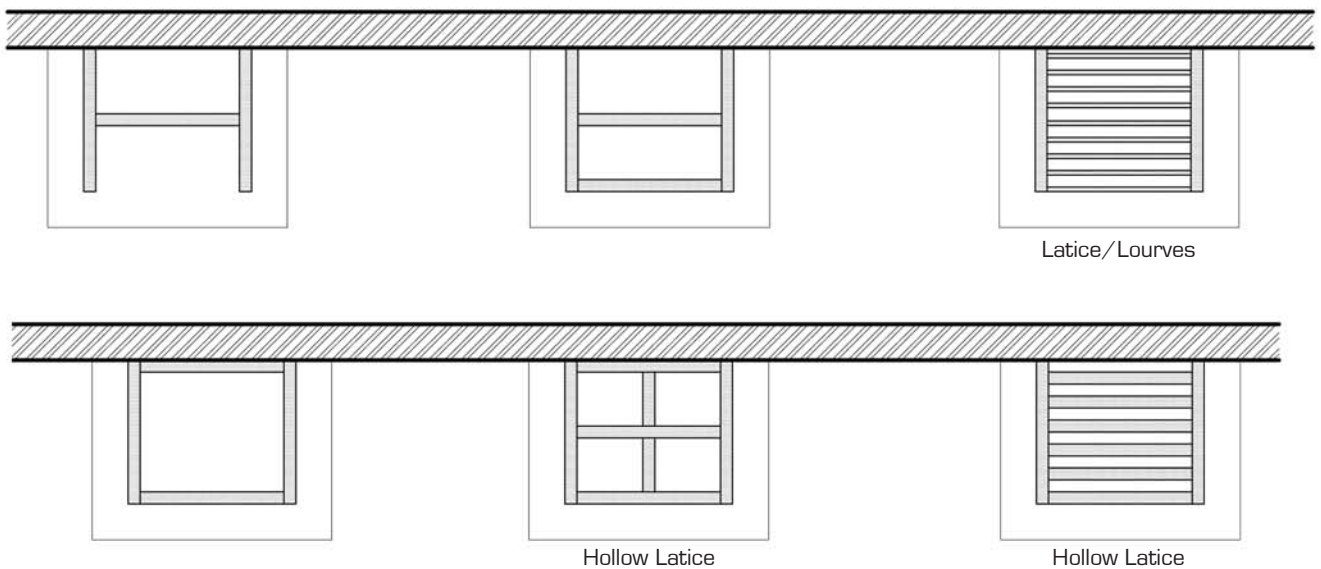

3D Visual

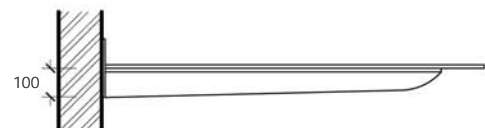
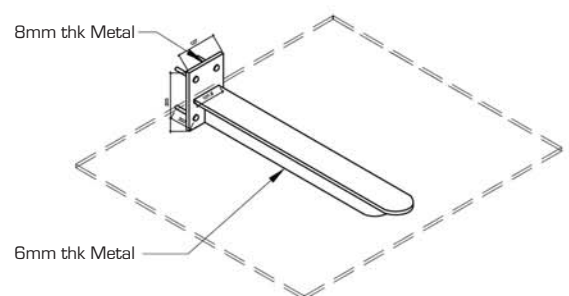
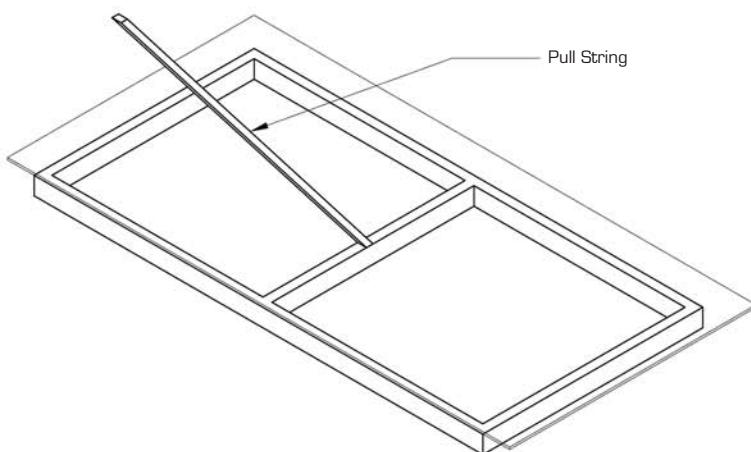

- * Wall must minimum 6" height
- * Concrete
- * If without concrete must use pole or pull string

SKYLIGHT METAL STRUCTURE CHOICE



Hollow T Bar

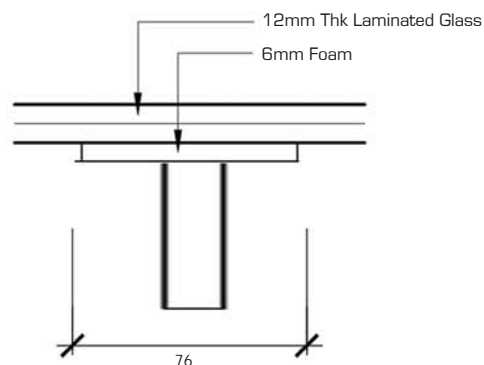

Wave T Bar

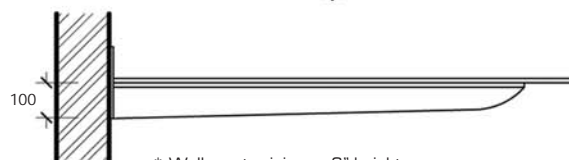
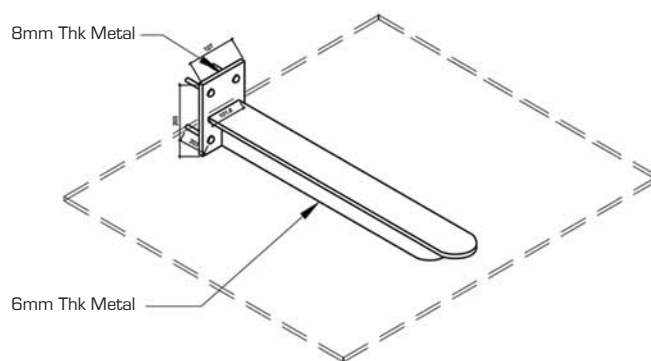

- * Wall must minimum 6" height
- * Concrete
- * If without concrete must use pole or pull string



Origin T Bar

3D Visual

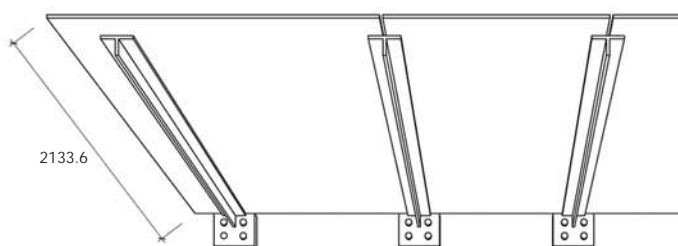

In our skylight series, we provide two types of glass :-

1. Tempered Glass- 12mm or 15mm or more Thickness
2. Double Layer- Laminated Glass PVB Film 12.38mm or 12.78mm

We provide on-site consultation on the structural works and find out the best solution designs to your skylight/glass roof.

3D Visual



Hollow Type

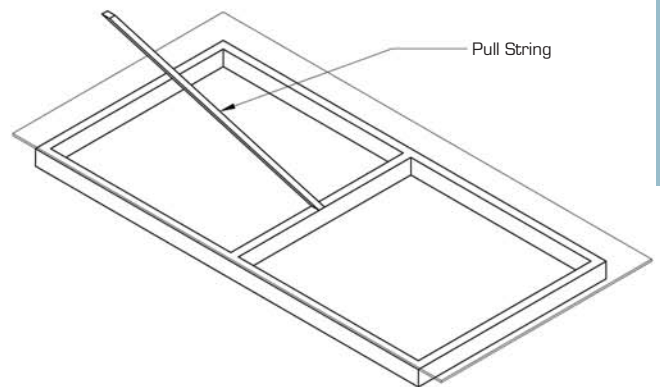

TOP VIEW

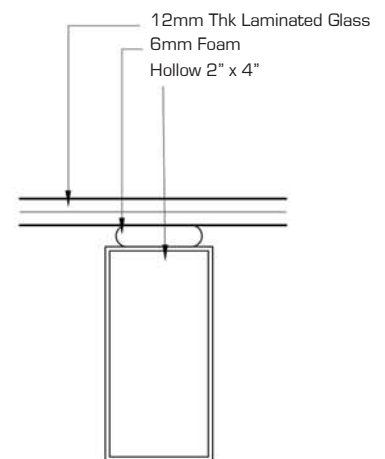
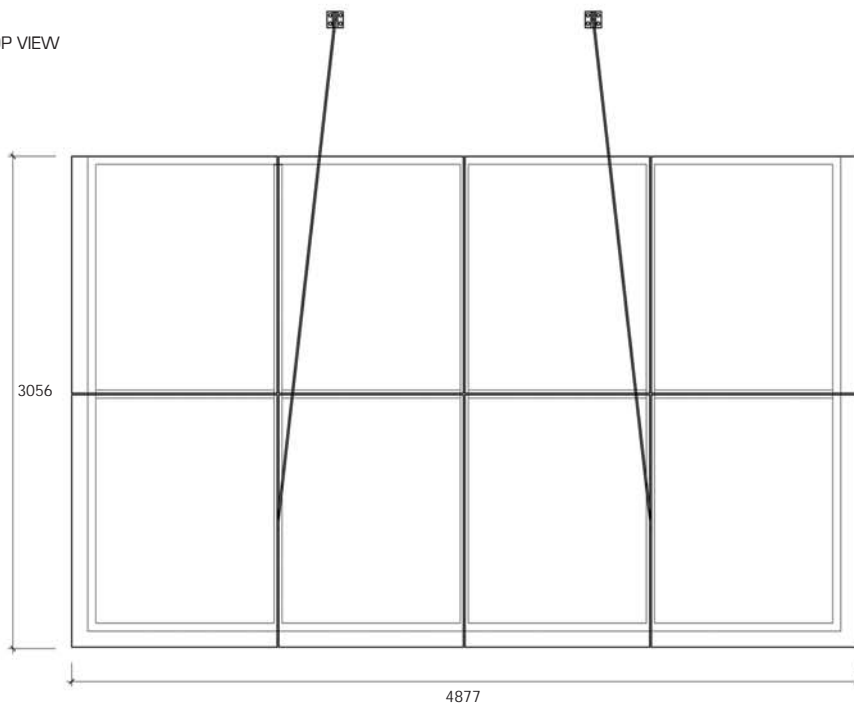

3D Visual



Pigeon T Bar

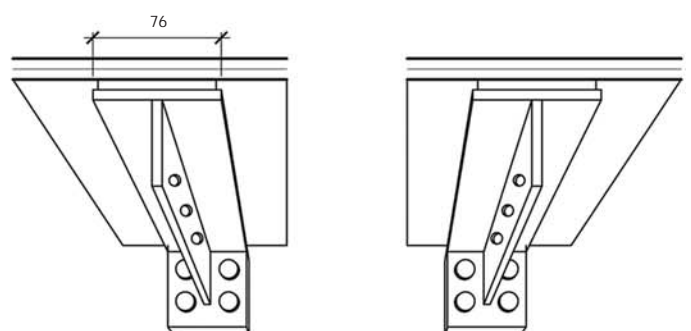



Daylighting through the introduction of skylights in your building reduces the need to use energy sapping artificial lighting. At the same time it can enliven a building by bringing the outdoor environment indoors, improve safety, generate warmth and ultimately improve the living experience of the building inhabitants.





Skylight Glass

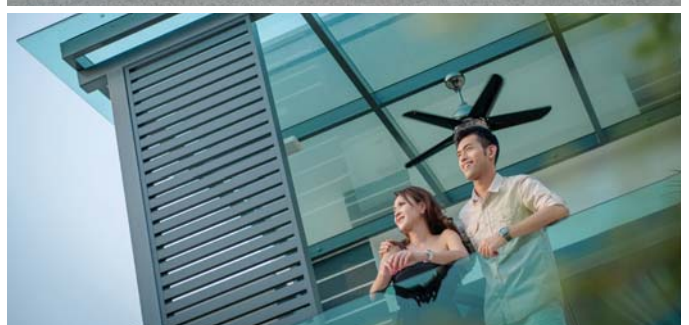

CUSTOMER PHOTO GALLERY

