



**RELIANCE
HOME**

Built for Better Home

2019 Product Catalog



OPEN 7 DAYS

Showroom : *(Except Headquarter Office)*

Mon-Sat : 9:30am - 7:00pm

Sunday : 10:30am - 5:00pm

HEAD QUARTERS

No. 3, Jalan Taming 2A,
KWS. Perindustrian Taming Jaya,
43300 Balakong, Malaysia.
Tel : +603-8211 2082 (12 Lines)
Fax : +603-8962 3688
www.reliancehome.com
sales@reliancehome.com

CHERAS

No. 62 Ground Floor,
Jalan Cerdas, Taman Connaught,
Cheras 56000 Kuala Lumpur.
Tel : +603-9100 5094
HP : +6012-622 6955
cheras@reliancehome.com

DAMANSARA UPTOWN

No. 98G, Jalan SS21/39,
Damansara Utama,
47400 Petaling Jaya, Selangor.
Tel : +603-7729 3888
HP : +6012-622 6598
damansara@reliancehome.com

PUCHONG

No. 9, Jalan Puteri 2/1,
Bandar Puteri Puchong,
47100 Puchong, Selangor.
Tel : +603-8060 3885
HP : +6012-622 6597
puchong@reliancehome.com

eSTORE
<http://reliancehome.com/shop/>

THE LUXE CASEMENT WINDOW



THE LUXE

MATERIAL SPECIFICATION

Lock System : MultiPoint Security Lock

Glass Thickness : 6.38 - 8.38mm

Frame Color : Dupont / Jotun Outdoor Coating

Aluminum Extrusion Thickness : ±1.8-2.00mm





THE PRESTIGE CASEMENT WINDOW



THE PRESTIGE

MATERIAL SPECIFICATION

Lock System : MultiPoint Security Lock

Glass Thickness : 6.38 - 8.38mm

Frame Color : Dupont / Jotun Outdoor Coating

Aluminum Extrusion Thickness : ±1.8-2.00mm



THE PRESTIGE

CASEMENT WINDOW

ABS Lock Handle



- Reliable** under heavy use
- Low-noise** function (silent pattern)
- Heavy duty** High Durability & Quality

4-Bar Hinge (Heavy Duty)



1. **SUS304 stainless** steel made.
2. **Water and Rust Proof.**
3. **Heavy Duty** and able to hold heavy windows.
4. Engineered to project the vent out as it pivots to avoid interference between a lipped vent and frame.
5. **High sustainability** to withstand strong wind or inverse force.



Thick & Strong (Aluminum Profile)



Unobstructed view



Powder Coated Frame



- Fluorocarbon chemistry technology
- Highest Color Retention**
- RUST PROOF** water repellent
- UV FILTERED** Protection
- VOC FREE** Paint powder
- ANTIDUST** surface easy for cleaning



HD
HEAVY DUTY

3RD GENERATION INDUSTRIAL NYLON Bearing Roller



Multiple Lateral Locks against Intruders

Multiple Locking Points to keep the doors tight and secure

Smooth Chamfered deadbolts in lock cases

Reduce excessive noise and energy wastage

Excellent weather sealing for thermal insulation and energy economy

Resistant to lateral thrust forces

Multipoint Lock
2 YEARS WARRANTY



Saflex 
Made in USA

SAFETY Anti Shattered

SECURITY 10X Stronger

SOUND Reduce 70% sound trans

UV PROTECT Filter more than 99% harmful UV rays



STRESS TESTED

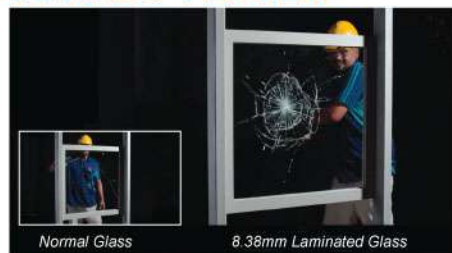

Normal Glass 8.38mm Laminated Glass
IMPACT STRESS TEST
(Baseball Bat and Steel Hammer)



>80KG
Punching Bag hitting the glass! The glass stands still WITHOUT BREAKING!
Strong & Safe Glass
Laminated Glass
Zoom in view



>150KG
Two men jumping on top of the glass, the glass bend WITHOUT BREAKING!
Laminated Glass
Zoom in view
Glass Weight Sustainability STRESS TEST
(performed by 2 person weighted more than 150KG)

* Above three stress tests were performed at our factory, Balakong. Please visit our Youtube Channel to watch these videos.



TOP HUNG WINDOW

THE LUXE

MATERIAL SPECIFICATION

Lock System : MultiPoint Security Lock
 Glass Thickness : 6.38 - 8.38mm
 Frame Color : Dupont / Jotun Outdoor Coating
 Aluminum Extrusion Thickness : ±1.8-2.00mm



| Multi Point Locking System |



Surface Finishes : Glossy Polish/Matt
 Material : SUS 304 Stainless Steel
 Function : Pivot Door
 (Outward)

| Bar Hinge System |



Surface Finishes : Glossy Polish/Matt
 Material : SUS 304 Stainless Steel
 Function : Pivot Door
 (Outward)

SLIDING WINDOW

THE LUXE



Frame Material : Aluminium
Aluminium Thickness : 1.6mm

Aluminium Grade : 6063-T5

Infil Panel : 6.38mm - 8.38mm
Laminated Glass

Locking System : Embedded Handle

A5 Handle : Zinc Die Cast
Embedded C Handle : Aluminium



Embedded
A5 Lock



Embedded
C Handle

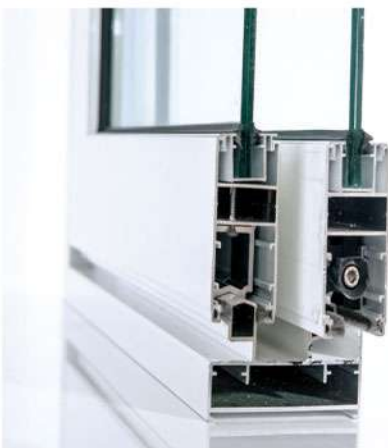

Aluminum
Extrusion



HANDLE CHOICE



Lock System : Zinc Die Cast Security Lock
Color : Black / White

Lock System : MultiPoint Security Lock
Color : Black / White



MULTI SLIDING DOOR

Smooth Gliding Experience



Heavy Duty Roller
Made from industrial nylon
Support up to 120KG/leaf



Rust Proof
Durable Powder Coated
Aluminum Frame



Deep Bottom Track
Make it harder from
lifting the door panel



**Strong Anti Jump
Track System**
Enhanced Security feature



Security Lock
4 Hook lock-in System



Thick & Strong
Aluminum Extrusion



Non-Shattered Glass
Two layer laminated glass



**MoHair
Weather Strip**
- Sound Reduction
- Dust/Rain Filter
- Keep out of weather



Stopper
Reduce collision sound



Easy Cleaning
Water & Rust Proofing



Model: Multi Sliding Door

Custom Made just for you

Frame Finish	Powder Coated (Available in Black ,Grey and White)
Glass Type	3mm+0.38+3mm (Upgrade Optional 4mm+ 0.38 + 4mm)
Accessories	Die Cast Zinc Lock
Product Name	MultiSliding Door (Exterior Door)
Frame Color	Matte Black (Exterior Weatherproof Powder Coating)
Product Style	Modern
Product Origin	Malaysia (Selangor)
Production Time	14 working days (Longer during peak season)
Terms & Con	Minimum two doors ,minimum sqft is 42sqft, which is size is 6' x 7' H (1800mm x 2100mm), for size below this size will still be calculated as 42sqft.

EXTRA FEATURES : ALL PRODUCTS COMES WITH TWO YEARS WARRANTY AND TWO YEARS WARRANTY WITHIN KLANG VALLEY ONLY. FOR SUPPLY ONLY, NO WARRANTY GIVEN EXCEPT FAULTY MANUFACTURING ACCESSORIES.

2 Tracks

2-leaf
2 tracks

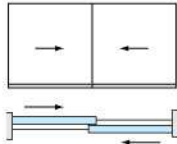

4-leaf
2 tracks

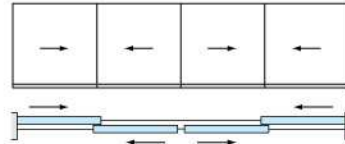

Integrated composite
2-leaf

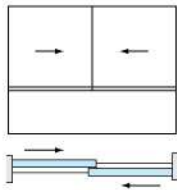

3 Tracks

3-leaf
3 tracks

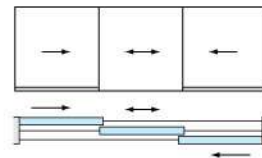

3-leaf joined
2 tracks

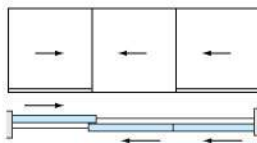

6-leaf
3 tracks

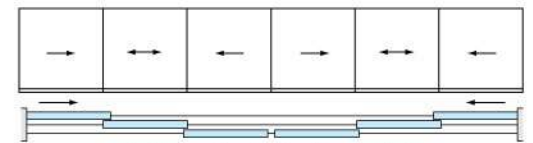

3-leaf independent
2 tracks

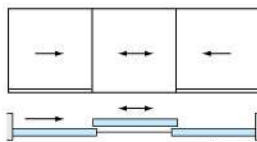

4 Tracks

4-leaf
4 tracks

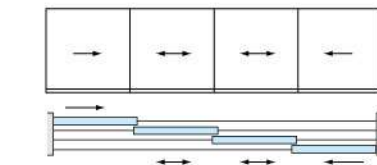



Multi Sliding Door

Designed for Sound Reduction



Indoor Noise Reduced

Saflex

Dust & Noise Seal

REDUCE NOISE EFFECTIVELY DOWN TO **40dp**

The diagram shows a multi-sliding door with a sound wave being blocked by the door. A circular inset shows a close-up of the 'Dust & Noise Seal' on the door's edge. The text 'Indoor Noise Reduced' is written inside the door frame. The Saflex logo is prominently displayed. At the bottom, it states 'REDUCE NOISE EFFECTIVELY DOWN TO 40dp'.

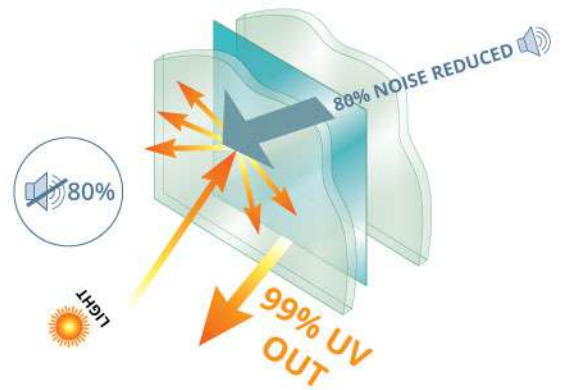

Door Opening Mechanism



2 Door Series
No. of Panel
2 + 0

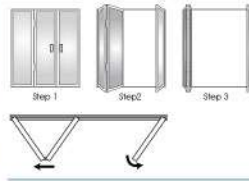

3 Door Series
No. of Panel
2 + 1

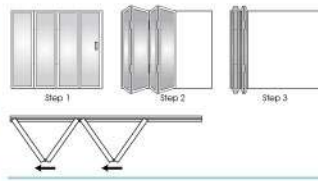

4 Door Series
No. of Panel
4 + 0

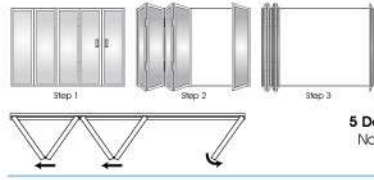

5 Door Series
No. of Panel
4 + 1

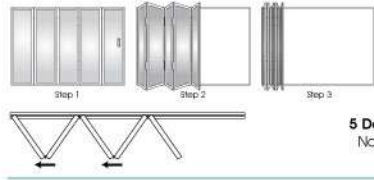

5 Door Series
No. of Panel
5 + 0

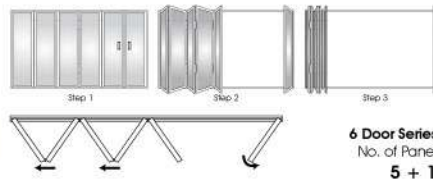

6 Door Series
No. of Panel
5 + 1



3 Door Series
No. of Panel
3 + 0

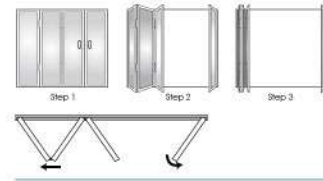

4 Door Series
No. of Panel
3 + 1

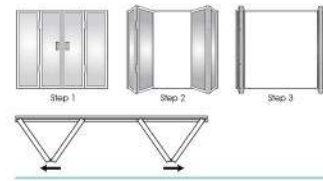

4 Door Series
No. of Panel
2 + 2

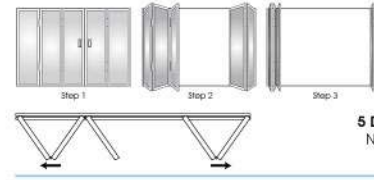

5 Door Series
No. of Panel
3 + 2

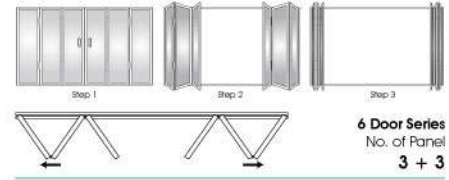

6 Door Series
No. of Panel
3 + 3

Sliding ⇌ Swing ↻





THE LUXE SERIES

THE PRESTIGE SERIES



Multipoint Safety Lock
For better security against adverse force
(SUS304 S/Steel)

Latch & Lock



What's THE LUXE more compare to THE BASICS?

Concealed Hinge Bar
Provides sleek & solid view

Highgraded ABS Lock Handle



Thicker & Heavier Alum Frame Profile

More Heavy Duty Roller System
Size up to 3'x 12'H per panel

	Center Bar Concealed	Folding Panel Latch or Handle?	Folding Hinge	Concealed Bar Hinge
THE PRESTIGE SERIES	 Yes	 Handle Bar	 3 Sectional	 Yes
THE LUXE SERIES	 No	 Latch	 2 Sectional	 No

MULTI FOLDING DOOR

Color Choice

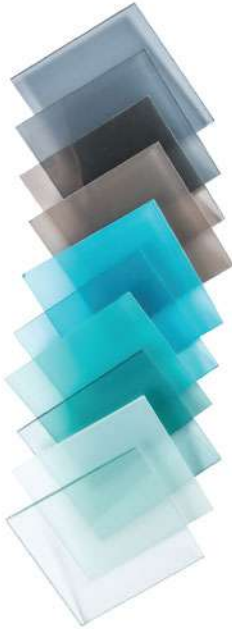

LAMINATED SAFETY GLASS

1. 10X times stronger than normal glass
2. Filter 99% UV Ray
3. High heat resistant
4. High Force/stress resistant
5. NON Shattered when break.
6. Reduce 70% Sound transmission
7. Burglary Protection (Forced-entry Resistant)
8. Storm Protection (Strong wind resistant)



SAFETY	Anti Shattered
SECURITY	10X Stronger
SOUND	Reduce 70% sound trans
UV PROTECT	Filter more than 99% harmful UV rays

FRAME COLOR (POWDER COATED)



- Fluorocarbon chemistry technology
Highest Color Retention
- RUST PROOF** water repellent
- UV FILTERED** Protection
- VOC FREE** Paint powder
- ANTIDUST** Surface easy for cleaning

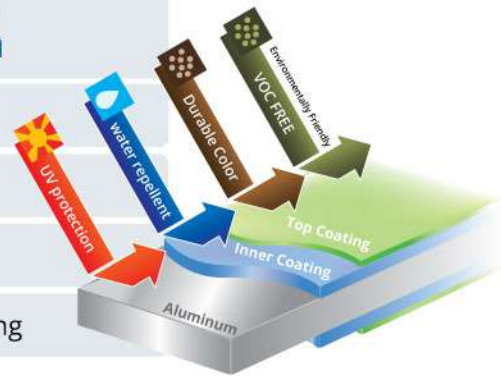



3RD GENERATION



MULTIPOINT LOCKING SYSTEM

- Multiple Lateral Locks against Intruders
- Multiple Locking Points to keep the doors tight and secure
- Smooth Chamfered deadbolts in lock cases
- Reduce excessive noise and energy wastage
- Excellent weather sealing for thermal insulation and energy economy
- Resistant to lateral thrust forces

FOLDING HINGE (HEAVY DUTY)

Resistant to lateral thrust forces Heavy Duty Roller System

1. In the bottom part of the door, a carriage mounted on needle bearings slides in the threshold section.
2. The guiding threshold section is designed for dismantling-free cleaning and maintenance.
3. In the top part of the door, a hinge fitted with guiding rollers slides in the rail section.

WHY Industrial Nylon Roller?

- ✓ HIGH Fracture Resistant
- ✓ HIGH load capacities
- ✓ HIGH Impact Resistant
- ✓ HIGH Wear & Tear Resistant
- ✓ HIGH Abrasion Resistance
- ✓ HEAVY Duty



ABS HANDLE LOCK Security Enhanced!

- ✓ Reliable under heavy use
- ✓ Low-noise function (silent pattern)
- ✓ Heavy duty usage in everyday life calls for durability.

ABS HANDLE LOCK Security Enhanced!

Intermediate doors shoot bolts operated by flush handles **disable attempt** to lift the doors off the track.



Easy Cleaning
Water & Rust Proofing



Thicker & Stronger
Aluminum Extrusion



Mohair Weather Strip
- Sound Reduction
- Dust/Rain Filter
- Keep out of weather



Rust Proof
Durable Powder Coated
Aluminum Frame

Balcony & Staircase Glass
Outdoor & Indoor Series



Embedded U-Channel



Nut Holder



4S606

Staircase Model



4S101



4S202



4S303



4S404



4S505

All Types of Glass Rail



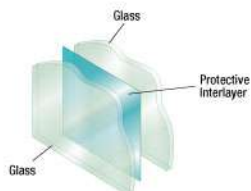

Benefits of Laminated Glass

Safety

- Meets all the national safety glazing standards (ANSI Z97.1 CPSC 16 CFR 1201 – Cat II)
- Resist penetration, won't shatter into dangerous fragment

Sound

- Typical STC (Sound Transmission Class) ratings between 34 to 40*
- Can reduce perceived noise by up to 50% Typical STC (Sound Transmission Class)

Security

Standard LAG (1/4" with 0.060" thickness) provides a significant improvement in resistance to attack from a variety of hand held weapons in: Rock, Hammer, Pry bar, Brick, Chisel, Axe, etc.

Solar

Screens out 99% of harmful & damaging UV rays up to 380 nm (= SPF 50+) Protects delicate plants, fabrics, carpets, and furniture from fading.

Solar Data	Test method	clear glass	Visible light (D65)	Solar
Transmission	ISO 9050 / EN410 / NFRC 300	2 x 3.0 mm	88%	71%
Reflection	ISO 9050 / EN410 / NFRC 300	2 x 3.0 mm	8%	7%
Absorption	ISO 9050 / EN410	2 x 3.0 mm	4%	22%
Solar Heat Gain Coefficient (SHGC)	NFRC 300	2 x 3.0 mm	0.80	
Light to Solar Gain (LSG)		2 x 3.0 mm	1.10	
UV Blocking	Wavelength Damage Weighted	2 x 3.0 mm	300 - 800 300 - 400	>99% >96%



Skylight Metal Structure Choice



Hollow Type



Hollow T-Bar



Wave T-Bar



Pigeon T-Bar



Origin T-Bar



NEW



| Various of Infill Panel Choices |



5th GENERATION STAINLESS STEEL Bearing Roller

HD
HEAVY DUTY

2 YEARS WARRANTY

5th GENERATION

- ✓ 5x Stronger
- ✓ 5x Smoother
- ✓ 5x Durable
- ✓ 5x Stronger

Suspended Roller



- ➔ 100% Rust Proof Materials
- ➔ Heavy Duty Bearing System
- ➔ Strong Aluminum Profile to sustain the glide system
- ➔ Smooth & Silent Roller System



Lock System

Quality Lock Push Up to open Locking System.
Sleek Embedded Handle Space saving and child injury prevention.



Powder Coating Frame

VOC FREE Eco Friendly
UV Filtered Resists to UV and Acids.
No Paint Runs Absolute smooth surface.
Wide Range of Color
Pick your Favorite!

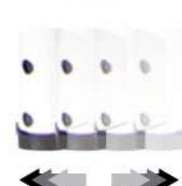

3rd Generation Track

for Effortless gliding experience.
Track Lock System
Door will not fall off the track easily.

www.reliancehome.com/catalog

1 Frame Color Choice



2 Laminated Glass



3 Acrylic Panel



4 Ecopanel Graphic





Water
Rust
PROOF

KOREAN UV PRINT TECHNOLOGY AT ITS BEST



FD117



FD115



FD118



FD113



FD113



FD112



FD116



FD111



FD117 - Eco

UV-Protective Green Technology



Introducing "Eco-Solvent" ink, which is a VOC FREE and environmentally friendly materials for green printing.

WATER PROOFING

Our final layer of lamination provides a water-proofing shield to our artprints.

HIGH SCRATCH RESISTANCE

Every EcoPanel print is coated with a protective, scratch-resistant UV laminate.

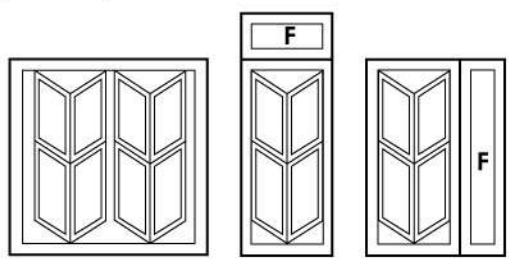

Types of Door Mechanism



FD117+
1/3 LOUVRES



FD117+
1/2 LOUVRES



FULL LOUVRES

HANGING SLIDING DOOR

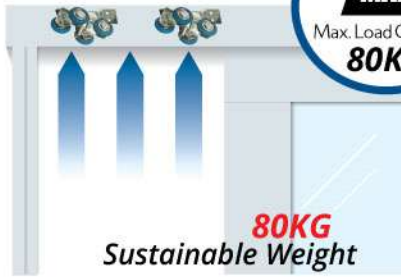

HD HEAVY DUTY

2 YEARS WARRANTY

3rd GENERATION

- ✓ **HIGH Fracture Resistant**
- ✓ **HIGH load capacities**
- ✓ **HIGH Impact Resistant**
- ✓ **HIGH Wear & Tear Resistant**
- ✓ **HIGH Abrasion Resistance**
- ✓ **HEAVY Duty**



Double Layer Laminated Glass

1. 10X times stronger than normal glass.
2. NON Shattered when break.
3. Reduce 70% Sound transmission.
4. High heat resistant.
5. High Force/stress resistant.
6. Burglary Protection (Forced-entry Resistant)
7. Filter 99% UV Ray
8. Storm Protection (Strong wind resistant)



Lock System

Quality Lock Push Up to open Locking System.

Sleek Embedded Handle Space saving and child injury prevention.



Powder Coating Frame

VOC FREE Eco Friendly

UV Filtered Resists to UV and Acids.

No Paint Runs Absolute smooth surface.

Wide Range of Color

Pick your Favorite!



Smooth Glide

No Bottom Track

- ✓ Children Friendly Door.
- ✓ No bottom track that causes accumulation of dusts and dirt.
- ✓ No coordination track problem.



NO BOTTOM TRACK!





SlidingPRIME

FEATURES:

- ✓ **Top Hanging Track (No Bottom Track).**
- ✓ **Aluminum Frame > Water Proof & Rust Proof.**
- ✓ **Industrial Nylon Made Heavy Duty Roller.**
- ✓ **Smooth Gliding experience.**
- ✓ **Fully Custom made**, choose your design and color.
- ✓ **Affordable & Practical.**
- ✓ **More than 20 years** of manufacturing Experience.
- ✓ **Oil Proof**, high scratch resistant.
- ✓ **Solid and Durable.**
- ✓ **3 Types** of materials to choose:
 1. Laminated glass
 2. Acrylic Panel
 3. Graphic Eco Panel

Aluminum Swing Door





Door Hinge

Heavy Duty
Made to sustain heavy weight Door

Made from SUS304 Stainless Steel
Stainless Steel Door Hinge.

Durable for 100k Opening & Closing Operations

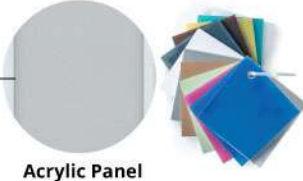

Acrylic Panel

VOC FREE Eco Friendly
High Thermal Resistance
Durable & Strengthened

Wide Range of Color
Pick your Favourite!



Lock System

Quality Lock Push to Lock and turn to Unlock

Stainless Steel
Water and rust proof



Powder Coating

VOC FREE Eco Friendly
UV Filtered Resists to UV and Acids.
No Paint Runs Absolute smooth surface.

Wide Range of Color
Pick your Favourite!



No Bottom Track

Children Friendly Door
No bottom track that causes accumulation of dusts and dirt.

Aluminum Swing & Sliding Door Model Selection

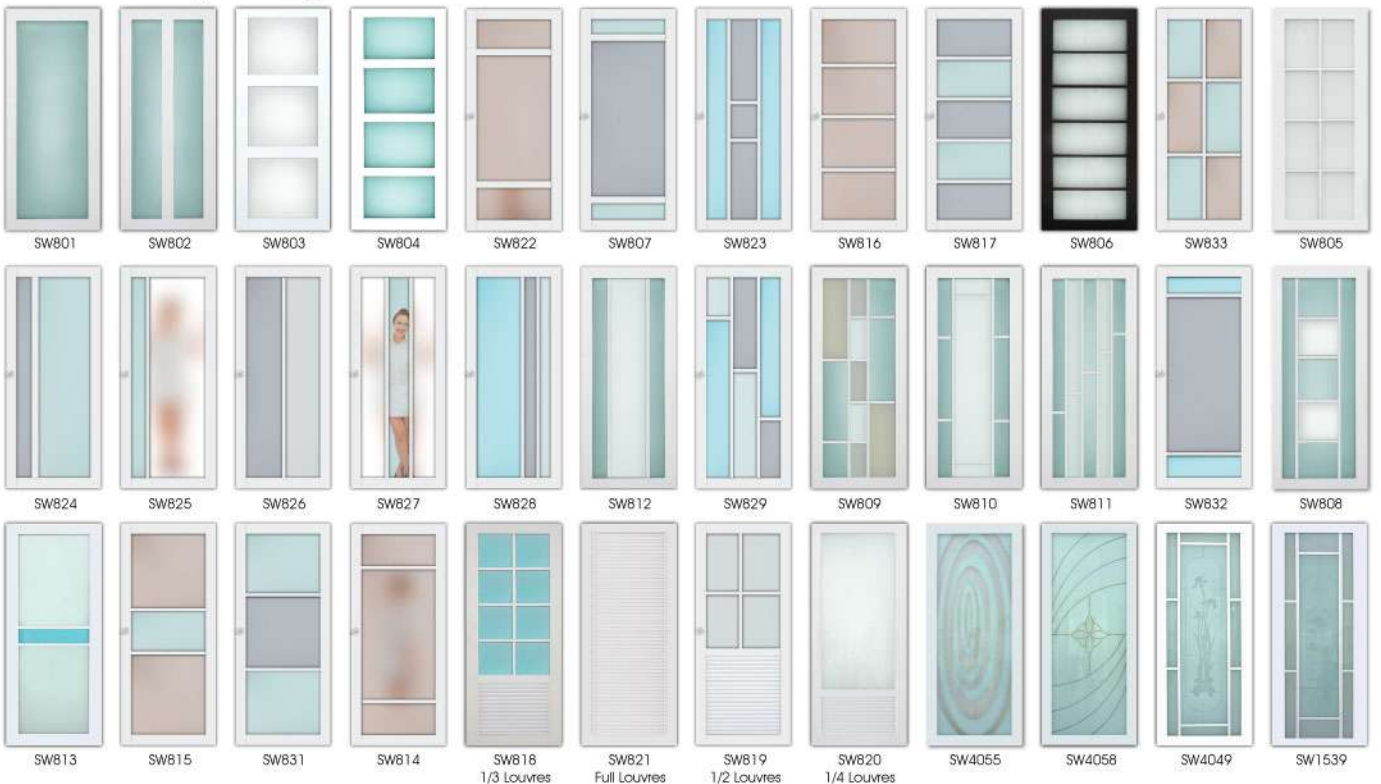



Kitchen Door



Walk in Wardrobe



Shoe Room Door



Bathroom Door



Closet Door



Dividing Hall



Yard Door

- ✓ No Bottom Track
- ✓ Water-Proofing
- ✓ Rust-Proof
- ✓ Heavy Duty Roller
- ✓ Custom Made
- ✓ 2 Years Warranty



Wet/Dry Kitchen

Sliding Door

Lockset Choice



A5/A6 YM-6 ZL-102 RB Lock MultiSliding Lockset (Black/White) C Handle L-106 (ø 20mm)

Swing Door

Lockset Choice



Safety Lock (Silver) Round Lock (Silver/Bronze) Lever Lock (Square Lock) SLAP6504 (Square Lock)



Kitchen Door



Wardrobe Door



Study Room Door



Kitchen Door



Bathroom Door



Office Meeting Room



Entertainment Room



Study Room Door



Living Hall to Garden



Toilet Door



SAFETY is the best Insurance for yourself and your family.

防爆玻璃，
保护你的一家

- SAFETY** **Anti Shattered**
- STRENGTH** **10X Stronger**
- SECURITY** **Superior Edge Stability**
- SUSTAIN** **Higher uniform loads after breakage**

STRESS TESTED

Normal Glass HydroSafe™ Glass

TEST PERFORMED AT THE LAB OF St. Louis, Missouri

Multiple stress tests performed on HydroSafe™ Glass

>80KG
Flouring Bag hitting the glass! The glass stand still WITHOUT BREAKING!
Strong & Safe Glass

>150KG
Two men jumping on top of the glass. The glass bend WITHOUT BREAKING!

More than 80KG sand bag hitting the HydroSafe™ Glass multiple times, the glass show no sign of breakage.

More than 150KG weight of two men bouncing on top of the glass, the glass bend without breaking.

Glass was hitten by steel hammer, the glass holds together when shattered, reduce the risk of injury to the lowest.





Make your life
much **EASY!**

HydroSafe™ Glass

- ✓ Reduce your shower cleaning time!
 - ✓ Water Repellent Surface (Nano Technology)
- *The effectiveness of repellent surface subject to the usage, maintenance and care of the users, no warranty is given.

NEW

- ✓ Anti-Explosion
- ✓ Water Repellent Surface

- ✓ 10 times stronger than normal glass
- ✓ High resistant to impact
- ✓ Higher Bending strength
- ✓ High heat resistant
- ✓ High Force/stress resistant
- ✓ Protect against serious injuries

"HydroSafe™ Glass made my cleaning effortlessly! I can have more time to spend with my family" - Katherine, Housewife



Multiple stress water tests performed on HydroSafe™ Glass

HydroSafe™ Glass Care Instruction:



1. HydroSafe™ Lamination is a scratchable material, avoid contact with any cleaning tools which comes with rough surface. (e.g plate sponge, polishing tools, paper, glass cleaning wipes, glass cleaner tools and/or any possible material that may cause a scratch).
2. Wipe your HydroSafe™ Glass with a delicate cloth and slightly dampened cloth.
3. Avoid using any acidic or chemical detergent, detergents, glassware detergents or related glass cleaner material on HydroSafe™ Glass surface as it may damage the effectiveness of the HydroSafe™ Glass.

REH Shower Series



MODEL: REH100 SSL / SUS304 Stainless Steel Header & Handle
G. Thickness: 10mm Clear Tempered



MODEL: REH100 Single Glass Door
G. Thickness: 10mm CTG



MODEL: REH100 SR / Frame: Silver Chromed Polish
G. Thickness: 10mm Clear Tempered / Header: S. Steel 304



MODEL: REH100 AL / Frame: Aluminium Anodised
G. Thickness: 10mm Clear Tempered / Header: Aluminium



MODEL: REH100 SQ / Frame: Silver Chromed Polish
G. Thickness: 10mm Clear Tempered / Header: S. Steel 304



MODEL: REH300 SQUALU / Frame: Silver Chromed Polish
G. Thickness: 10mm Clear Tempered / Header: S. Steel 304



NEW



MODEL: RS120 - 4mm PS
Frame: Anodised/ Powder Coated
Infil: Polystyrene Panel



MODEL: RS130 - 4mm 'S' TG
Frame: Anodised/ Powder Coated
Infil: 4mm 'S' Design Tempered Glass



MODEL: RS140 - 4mm CTG
Frame: Anodised/ Powder Coated
Infil: 4mm Clear Tempered Glass



MODEL: RS431 - Sliding Door
Frame: Anodised/ Powder Coated
Infil: 4mm Polystyrene Panel



MODEL: RS220 - Sliding Door
Frame: Anodised/ Powder Coated
Infil: 4mm CTG



MODEL: RS111 - Folding Door
Frame: Anodised/ Powder Coated
Infil: 4mm CTG



MODEL: RS109 - Folding Door
Frame: Anodised/ Powder Coated
Infil: 4mm CTG



MODEL: RS180Z - Folding Door
Glass: 8mm C.Tempered Glass
*c/w stainless steel handle



MODEL: RS5018P - Sliding Door
Glass: 8mm C.Tempered Glass
*c/w stainless steel handle



MODEL: RS5018P + Fix Panel
Glass: 8mm C.Tempered Glass
*c/w stainless steel handle



MODEL: RS5018PL - Sliding Door
Glass: 8mm C.Tempered Glass
*c/w stainless steel handle



MODEL: RB090R - 180 degree Swing Door
G. Thickness: 8mm CTG

NEW

2 Panels, 2 Way Sliding



MODEL: 5028P - 2 Way Sliding Door
Frame: Silver Chromed Polish
G. Thickness: 8mm Clear Tempered Glass



MODEL: KW-P51 - Swing out only
Material: Full SUS304 Stainless Steel
G. Thickness: 8mm Clear Tempered Glass
Size: 1200mm x 2000mm H
1400mm x 2000mm H



MODEL: KK-T11 - Bothside Sliding Door
Material: Full SUS304 Stainless Steel
G. Thickness: 8mm Clear Tempered Glass
Size: Custom Made



MODEL: KK-T41 - Sliding Door
Material: Full SUS304 Stainless Steel
G. Thickness: 8mm Clear Tempered Glass
Size: 985 x 985 x 2000mm H



Glass House



VVP Glass Door/Window



VVP Office Glass Partition



TG800 Glass Sliding Door



Alum. Glass Partition



Tempered Glass Room



TG800 Glass Door



Glass Dining Divider



Alum. Glass Divider



Aluminum Glass Partition



Study Glass Room



Closet Glass Door



Living Hall Glass Wall



Kitchen Glass Door



Roof Entertainment Room



Waiting Glass Lounge



Interior Glass Wall



Office Glass Door



Glass Leisure room



Aluminum Louver Fence



Glass Partition