



R™
RELIANCE HOME
Built for Better Home



Reference No: RLA-CAT15-01



1800-815-862



<http://www.reliancehome.com>



[facebook.com/reliancehomeservice](https://www.facebook.com/reliancehomeservice)

OPEN 7 DAYS

Showroom : - (Except Headquarter Office)
 Mon-Sat : 9:30am -7:00pm
 Sunday : 10:30am -5:00pm

WARRANTY:



AWARD WINNING MANUFACTURER :



HEAD QUARTER

No: 3, Jalan Taming 2A
 KWS Perindustrian Taming Jaya
 43300 Balakong
 Selangor D. E., Malaysia
 Tel: +603 8962 3288 (13 Lines)
 Fax: +603 8962 3688
sales@reliancehome.com

PUCHONG

No: 9, Jalan Puteri 2/1
 Bandar Puteri Puchong
 47000 Puchong
 Selangor D. E., Malaysia
 Tel: +603 8060 3885
 Fax: +603 8061 2588
puchong@reliancehome.com

DAMANSARA

No: 98G, Jalan SS21/39
 Damansara Utama
 47400 Petaling Jaya
 Selangor D. E., Malaysia
 Tel: +603 7729 3888
 Fax: +603 7729 7988
damansara@reliancehome.com

CHERAS

No: 62 Ground Floor
 Jalan Cerdas, Taman
 Connaught, Cheras 56000
 Kuala Lumpur, Malaysia
 Tel: +603 9100 5094
 Fax: +603 9100 5096
cheras@reliancehome.com

SHAH ALAM

No: 5-1-2, Jln Setia Prima
 (A) U13/A, Setia Alam
 Seksyen U13, 40170 Shah
 Alam, Selangor D. E., Mal
 Tel: +603 3341 6672
 Fax: +603 3341 9672
setiaalam@reliancehome.com

THE PRESTIGE

Casement Window (40C)

Premium Series

Barless View

Gives you the luxury of unblock view

Highgraded ABS Lock Handle

Pull upward & Downward to lock and unlock

MULTIPOINT LOCKING SYSTEM



- Better Security
- Better weather sealing performance
- Help reduce door warpage

SAFETY GLASS

Double Layer
Nonshattered
Safety Glass
(PVB: USA) ANSI Z97.1
CPSC 16 CFR 1201
- Cat 1

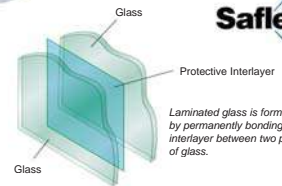

Laminated glass is formed by permanently bonding an interlayer between two pieces of glass.

- ✓ Filter more than 99% of UV rays, Controlling visible light radiation & reducing heat build-up & thermal stress
- ✓ Reduce the transmission of unwanted sound into building environment and highway
- ✓ 50% of worldwide architectural & safety security glazing using **Saflex**



HIGH QUALITY POWDER COATING FRAME (OUTDOOR)
Paint by Dupont or Jotun

HEAVY DUTY STAINLESS STEEL BAR HINGE
Smooth Gliding System

Fully Custom Made . Variety choice of Frame & Glass Colors . 2 Years Warranty.



| Multi Point Locking System |



Surface Finishes : Glossy Polish/Matt
Material : SUS304 Stainless Steel
Function : Pivot Door
(outward)



| Bar Hinge System |



Surface Finishes : Glossy Polish/Matt
Material : SUS304 Stainless Steel
Function : Pivot Door
(outward)



Pull Up Handle
To Unlock & Open



Unblock View
(Barless)



Pull Down Handle
To Lock & Open

| Material Specification |
| **FRAME** |

Frame Material : Aluminum
 Aluminium Thickness : 1.8 - 2.2mm
 Aluminium Grade : 6063-T5
 Infill Panel : 6.38mm - 8.38mm
 Double Layer
 Laminated Glass
 Locking System : Multipoint Locking
 Handle : Zinc Die Cast

| **DOUBLE LAYER LAMINATED GLASS** |

Safety & Standards

RELIANCE HOME Glass is safety glazing material, conforming to the requirements of

- CPSC 16FR 1201 Category I Performance
- CPSC 16FR 1201 Category II Performance criteria
- Underwriters Laboratories' UL972 Standard for Security Glazing
- Class 1 of the ASTM International's F1233 Security Glazing Test Standard.



MultiPoint Lock



(SUS304
Stainless
Steel)



For better security
against
adverse
force



THE LUXE

Casement Window



MULTIPOINT LOCKING SYSTEM
 - Better Security
 - Better weather sealing performance
 - Help reduce door warpage
(SUS304 Stainless Steel)



HIGHGRADED ABS LOCK HANDLE
(Pull lock and unlock)



DOUBLE LAYER NONSHATTERED Safety Glass (PVB: USA) ANSI Z97.1 CPSC 16 CFR 1201 - Cat 1

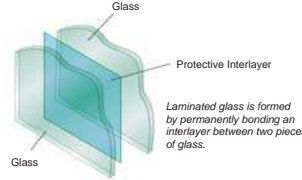

- ✓ Filter more than 99% of UV rays, Controlling visible light radiation & reducing heat build-up & thermal stress
- ✓ Reduce the transmission of unwanted sound into building environment and highway
- ✓ 50% of worldwide architectural & safety security glazing using **Saflex**

99% UV Filter



HIGH QUALITY OUTDOOR POWDER COAT
 Thicker and better weather resistance
 Frame coating system



HEAVY DUTY SUS304 STAINLESS STEEL BAR HINGE
 Smooth Gliding System



THE LUXE CASEMENT WINDOW



MULTIPOINT LOCKING & BAR HINGE SYSTEM

- Surface Finishes : Glossy Polish / Matt
- Material : SUS304 Stainless Steel
- Function : Pivot Door
- Glass : 6.38mm - 8.38mm Double Layer Laminated Glass

PRODUCT FEATURE:-

- ✓ Stronger Aluminum Frame Profile
- ✓ Safety Multipoint Lock
- ✓ Non-Shattered Laminated Glass
- ✓ Better Security
- ✓ Better weather sealing performance
- ✓ Help reduce door warpage

TOP HUNG WINDOW

- ✓ Stronger Aluminum Frame Profile
- ✓ Full S/Steel Accessories
- ✓ Multipoint Lock System
- ✓ Non-Shattered Laminated Glass

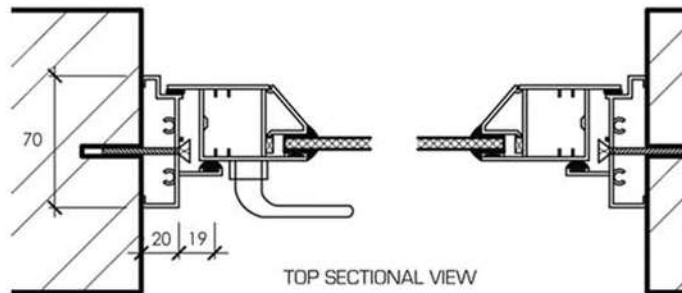

PRODUCT FEATURE:-

- ✓ Aluminum Frame c/w
- ✓ Water/Rust Proof with Center Bar
- ✓ Multipoint Lock System
- ✓ Non-Shattered Laminated Glass

THE SLIDING WINDOW



PRODUCT FEATURE:-

- ✓ Smooth Gliding System
- ✓ Seamless Embedded Handle
- ✓ Single Point Lock System
- ✓ Non-Shattered Laminated Glass

THE PRESTIGE SERIES (F03)

HIGH QUALITY OUTDOOR POWDER COAT
Thicker and better weather resistance
Frame coating system

DU PONT JOTUN

Center of Hook
MULTIPOINT LOCKING SYSTEM
- Better Security
- Better weather sealing performance
- Help reduce door warpage
(SUS304 Stainless Steel)

Center of Hook

Center of Hook
FOLDING BUTTERFLY HINGE (HEAVY DUTY)
- Bolted Folding Hinge Prevent Loosen Screw

HIGHGRADED ABS LOCK HANDLE

HIGHGRADED ABS LOCK HANDLE
Pull down to Lock

THICKER & STRONGER Aluminum Profile

MoHair Weatherstrip
- Sound Reduction
- Dust/Rain Filter
- Keep out weather

Saflex
Double Layer Nonshattered Safety Glass
(PVB:USA) ANSI Z97.1
CPSC 16 CFR 1201 – Cat I

Heavy Duty Roller System

1. In the bottom part of the door, a carriage mounted on needle bearings slides in the threshold section.
2. The guiding threshold section is designed for dis-mantling-free cleaning and maintenance.
3. In the top part of the door, a hinge fitted with guiding rollers slides in the rail section.

DOUBLE LAYER LAMINATED GLASS FACTS

Safety & Standards

- RELIANCE HOME** Glass is safety glazing material, conforming to the requirements of
- CPSC 16FR 1201 Category I Performance
 - CPSC 16FR 1201 Category II Performance criteria
 - Underwriters Laboratories' UL972 Standard for Security Glazing
 - Class 1 of the ASTM International's F1233 Security Glazing Test Standard.

Impact Performance

RELIANCE HOME laminated safety glass will resist penetration and will absorb the energy of the impact. The glass will remain intact when broken, with the glass fragments remaining firmly bonded to the interlayer, thus minimising the risk of injuries from sharp edges and falling glass.

Sound Reduction

The viscoelastic properties of the SAFLEX PVB Interlayer **RELIANCE HOME** used provide a dampening effect on the transmission of sound, thus reducing unwanted noise.

Security

If broken, laminated safety glass will remain intact in its frame and will continue to safeguard the building until the glass is replaced. Due to the tough PVB interlayer used, it will continue to provide protection and resistance to entry after the glazing is broken.

UV Control

The UV absorbing additive in the Saflex PVB interlayer used by **RELIANCE HOME** can screen out almost all of the sun's damaging UV rays, thus providing protection against discolouration and damage to fabrics, furniture, wall coverings, furnishings, artworks, etc.



THE LUXE SERIES



HIGH QUALITY OUTDOOR POWDER COAT
Thicker and better weather resistance
Frame coating system



HIGHGRADED ABS LOCK HANDLE



THICKER & STRONGER Aluminum Profile



Heavy Duty Roller System

1. In the bottom part of the door, a carriage mounted on needle bearings slides in the threshold section.
2. The guiding threshold section is designed for dis-mantling-free cleaning and maintenance.
3. In the top part of the door, a hinge fitted with guiding rollers slides in the rail section.



Center of Hook

MULTIPOINT LOCKING SYSTEM

- Better Security
- Better weather sealing performance
- Help reduce door warpage
(SUS304 Stainless Steel)

Center of Hook



FOLDING BUTTERFLY HINGE (HEAVY DUTY)

- Bolted Folding Hinge Prevent Loosen Screw



HIGHGRADED ABS LOCK HANDLE

Pull down to Lock



MoHair Weatherstrip

- Sound Reduction
- Dust/Rain Filter
- Keep out weather



Saflex



Double Layer Nonshattered Safety Glass
(PVB:USA) ANSI Z97.1
CPSC 16 CFR 1201 – Cat I



Saflex
Product of USA

Saflex

- ✓ Filter more than **99%** of UV rays, Controlling visible light radiation & reducing heat build-up & thermal stress
- ✓ Reduce the transmission of **unwanted sound** into building environment and highway
- ✓ **50%** of worldwide architectural & safety security glazing using **Saflex**

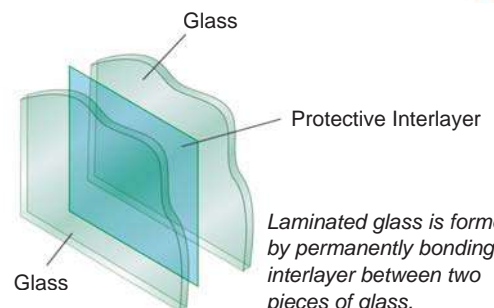

Laminated glass is formed by permanently bonding an interlayer between two pieces of glass.



Open up 90% Space
Gives you the luxury
of unblock view





THE PRESTIGE MULTIFOLDING DOOR

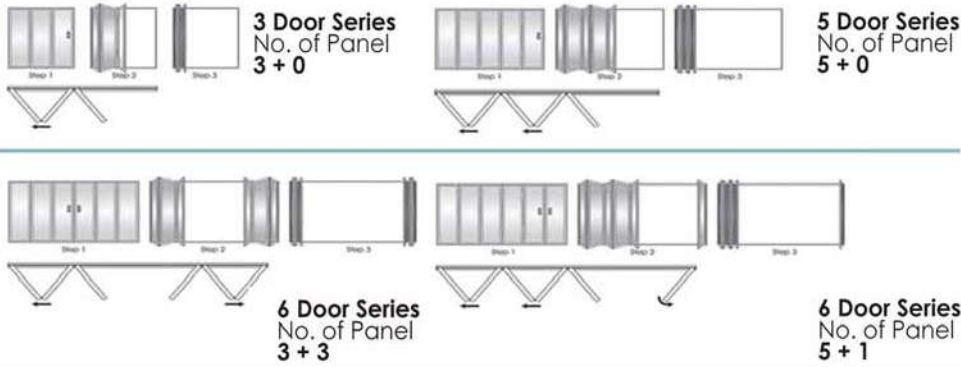

THE LUXE MULTIFOLDING DOOR

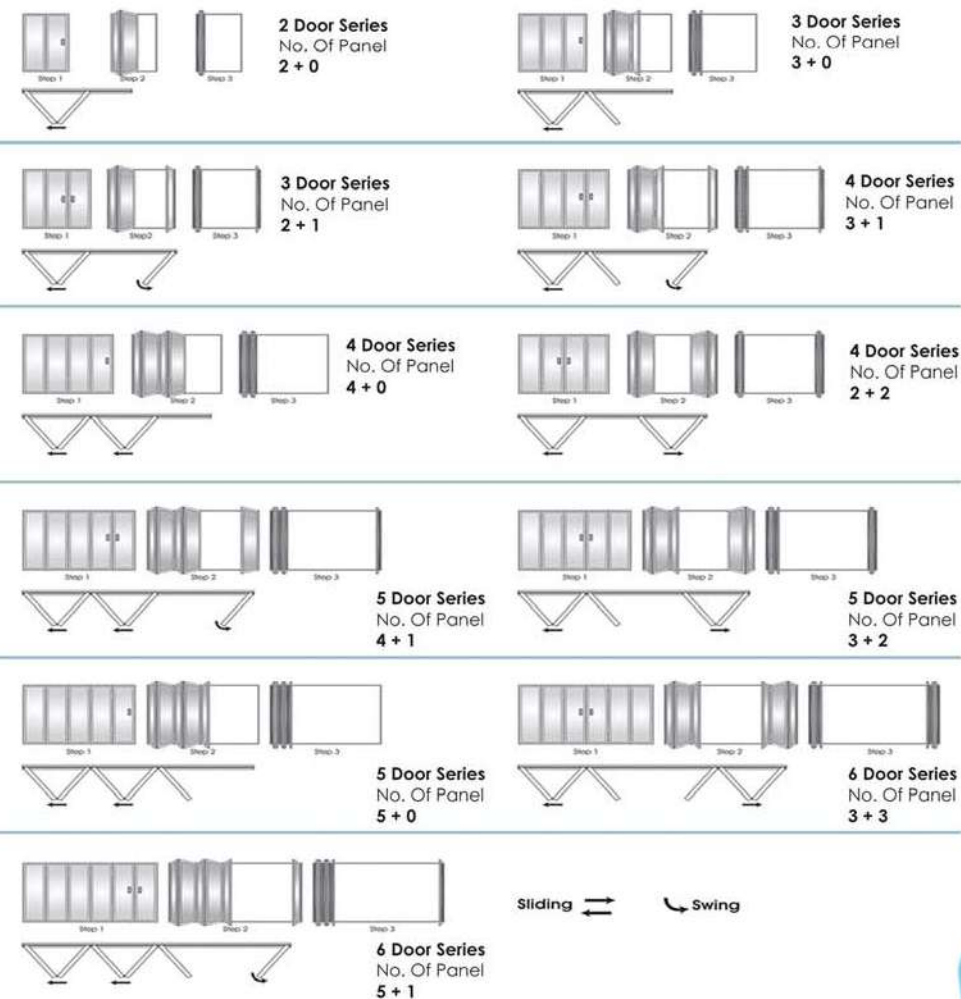

more here!

MultiSliding

Outdoor Series



High Quality Sliding System

- ✓ Lock 1 - Point thumb pull, up to 2-4 points lock with handle and key or level fingerpull
- ✓ On the bottom rail, an aluminium or stainless steel additional roller track gives the durability rollers bearing up to 140kg per leaf



Handle Option1:
Straight Sleek Hidden Handle



Handle Option2: Conventional Lock

Applications

2 tracks

2-leaf - 2 tracks



Integrated composite
2-leaf

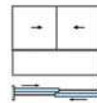

3-leaf joined
2 tracks

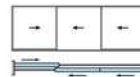

4-leaf
2 tracks

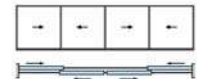

3 tracks

3-leaf
3 tracks

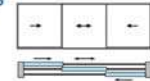

6-leaf
3 tracks

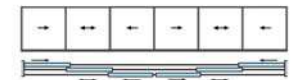

Product Specification

Frame Material : Powder Coated Aluminum

Glass : 6.38mm - 8.38mm
Double Layer
Laminated Glass

Function : Sliding Type

Page 10



MultiSwing

Outdoor Door Series



Security



MULTIPOINT LOCKING SYSTEM
For better security against adverse force
(SUS304 Stainless Steel)

Applications

1 or 2-leaf open-cut or open-in door

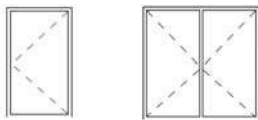

Wide choice of Frame Colours and Glass Colours



Saflex 
DOUBLE LAYER NONSHATTERED Safety Glass
(PVB: USA) ANSI Z97.1
CPSC 16 CFR 1201
- Cat 1



Balcony & Staircase Glass



Embedded Aluminum U-Chanel



AG001 S/Steel Glass Clip



4S606

Staircase Model



4S101



4S202



4S303



4S404



4S505

All Types of Glass Rail



AG105 SUS316 S/Steel Glass Holder



AG001 S/Steel Glass Clip



4S606

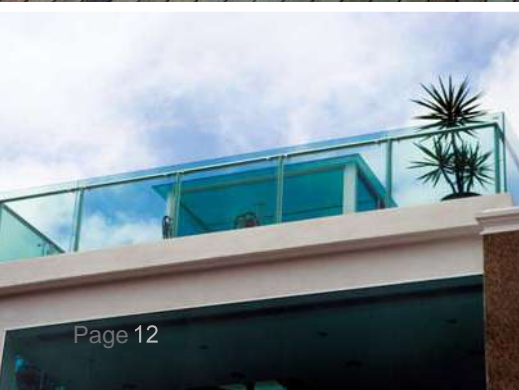

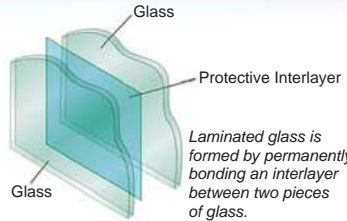

Laminated glass is formed by permanently bonding an interlayer between two pieces of glass.

Benefits of Laminated Glass

Safety

- Meets all the national safety glazing standards (ANSI Z97.1 CPSC 16 CFR 1201 – Cat II)
- Resist penetration, won't shatter into dangerous fragment

Sound

- Typical STC (Sound Transmission Class) ratings between 34 to 40*
- Can reduce perceived noise by up to 50% Typical STC (Sound Transmission Class)

Security

Standard LAG (1/4" with 0.060" thickness) provides a significant improvement in resistance to attack from a variety of hand held weapons in: Rock, Hammer, Pry bar, Brick, Chisel, Axe, etc.

Solar

Screens out 99% of harmful & damaging UV rays up to 380 nm (= SPF 50+) Protects delicate plants, fabrics, carpets, and furniture from fading

Solar Data	Test method	Clear Glass	Visible Light (D65)	Solar
Transmission	ISO 9050/EN410/ NFRC 300	2 x 3.0 mm	88%	71%
Reflection	ISO 9050/EN410/NFRC 300	2 x 3.0 mm	8%	7%
Absorption	ISO 9050/EN410	2 x 3.0 mm	4%	22%
Solar Heat Gain Coefficient (SHGC)	NFRC 300	2 x 3.0 mm	0.80	
Light to Solar Gain (LSG)		2 x 3.0 mm	1.10	
UV Blocking	Wavelength Damage Weighted	2 x 3.0 mm	300 – 380 300 – 400	> 99% > 96%

Our laminated glass has quality tested by the following certification bodies:-



Skylight Metal Structure Choice



Hollow Type



Hollow T-Bar



Wave T-Bar



Pigeon T-Bar



Origin T-Bar





Glass House



VVPGlass Door/ Window



VVPOffice Glass Partition



TG800Glass Sliding Door



Alum. Glass Partition



Tempered Glass Room



TG800 Glass Door



Glass Dining Divider



Alum.Glass Divider

ALL TYPES OF GLASS WORKS. GLASS PARTITIONS, ANY TYPE OF GLASS DOOR.
YOU NAME IT, WE MAKE IT FOR YOU.



Aluminum Glass Partition



Study Glass Room



Closet Glass Door



Living Hall Glass Wall



Roof Entertainment room



Waiting Glass Lounge



Interior Glass Wall



Kitchen Glass Door



Office Glass Door



Glass Leisure room



Aluminum Louvres Fence



Glass Partition



VOC-FREE

Green Technology

Introducing "Eco-Solvent" ink, which is a VOC FREE and environmentally friendly materials for green printing.

UV Protective

Bi-fold DOOR
Choose your door mechanism

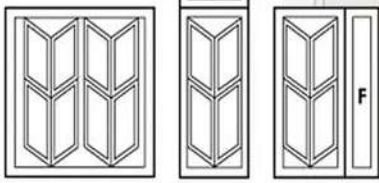

Stainless Steel Bearing Roller

NEW!
2X better!

- 100% Rust Proof Material
- Heavy Duty Bearing System
- Strong Aluminum Profile to Sustain the Glide System
- Smooth & Silent Roller System



High Quality Powder Coat (INDOOR)

Thicker and better weather resistance Frame coating system

Quality Handle Lockset



Quality Aluminum Extrusion



Bi - 4 Handle

Bi - 2 Handle

BIFOLD MODEL SELECTION



FD117

FD115

FD118

FD118

FD111

FD113

FD112

FD117
1/4 louvres

FD117+
1/2 louvres

FD115
full louvres

FD115
(SFN10904)

FD117
(SFN10214)

FD113

FD116

FD115



FD117 (SFN12307)



FD117 (SFN11324)



FD117 + 1/4 louvres



FD115



SL4055
Kitchen Door



SL801
Walk in Wardrobe



SL801
Shoe Room Door



SL1000
Bathroom Door



SL801
Closet Door



SL804
Kitchen Door



SL804
Yard Door

- ✓ No Bottom Track
- ✓ Water-proofing
- ✓ Rust-proof
- ✓ Heavy Duty Roller
- ✓ Custom Made
- ✓ 2 Years Warranty



SL822
Wet/Dry Kitchen

SLIDING DOOR

Lockset Choice



A5/A6 ZL-102 YM-6 R8 Lock MultiSliding Lockset (Black/White) C Handle (25mm) L-106

SWING DOOR

Lockset Choice



Safety Lock (Silver) Round Lock (Silver/Bronze) Lever Lock (Square Lock) SLA8504 (Square Lock)



SW811
Kitchen Door

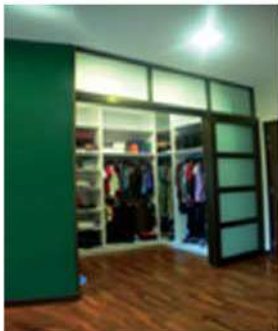

SW804
Wardrobe Door



SFN11819
Study Room Door



SL822
Kitchen Door



SL813
Bathroom Door



Office Meeting Room



SFN10219
Entertainment Room



SL804
Study Room Door



SW801
Living Hall to Garden



SW801 (SFN11300)
Room Door

Aluminum Swing & Sliding Door Model Selection



Quick Facts



Aluminum Frame
Water & Rust Proof

Stainless steel
Quality Lock

Variety Panel Choice
1. Acrylic
2. Laminated Glass
3. Eco Panel
4. Polystyrene Sheet

Material Section

Frame Color



Polystyrene Sheet Color Selection



Acrylic Color Selection



Laminated Glass Color Selection



Glass Type



All colors printed here may vary with the actual product!
Copyrighted by Reliance Home Sdn Bhd.

NEW



Model: REH100 SSL / SUS304 Stainless Steel Header & Handle
G.Thickness: 10mm Clear Tempered

Model: REH100 Single Glass Door
G.Thickness: 10mm Ceramic White Tempered Glass

REH Shower Series



Model: REH100 SR / Finish: Stainless Steel Glossy Polish
G.Thickness: 10mm Clear Tempered / Header: S.Steel 304



Model: REH100 AL / Finish: Aluminium Chromed Finish
G.Thickness: 10mm Clear Tempered / Header: Aluminium

NEW



Model: REH100 SQ / Finish: Stainless Steel Glossy Polish
G.Thickness: 10mm Clear Tempered / Header: S.Steel 304

NEW



Model: REH100 SQALU: Aluminium Chromed Finish
G.Thickness: 10mm Clear Tempered S.Steel 304

Swing Shower Series



Model: REH300 - 180° Hinge
 G.Thickness: 10mm Clear Tempered
 Track: Aluminium Chromed Finish
 Handle: SUS304 Stainless Steel



Model: REH200 - 135° Hinge
 G.Thickness: 10mm Clear Tempered
 Track & Handle: SUS304 Stainless Steel



Model: REH 400 - 90° Hinge
 G.Thickness: 10mm Clear Tempered
 Header & Handle: SUS304 Stainless Steel

Sliding Shower Series



Model: RS-5038P- 2 Slide + 1 Fix
 G.Thickness: 6mm Clear Tempered
 Track: Aluminium Chromed Finish
 Handle: SUS304 Stainless Steel



Model: RS-5028P- Both Way Sliding
 G.Thickness: 8mm Clear Tempered
 Track: Aluminium Chromed Finish
 Handle: SUS304 Stainless Steel



Model: RS-5018P- 1 Fix + 1 Slide
 G.Thickness: 8mm Clear Tempered
 Header: Aluminium Chromed Finish
 Handle: SUS304 Stainless Steel



Model: RS-5068P- 1 Fix + 1 Slide
 G.Thickness: 8mm Clear Tempered
 Header: Aluminium Chromed Finish
 Handle: SUS304 Stainless Steel



Model: RS-5068PL- 2 Slide + 2 Fix
 G.Thickness: 8mm Clear Tempered
 Header: Aluminium Chromed Finish
 Handle: SUS304 Stainless Steel



Model: RS-5018PL - 2 Slide + 2 Fix
 G.Thickness: 8mm Clear Tempered
 Track: Aluminium Chromed Finish
 Handle: SUS304 Stainless Steel



No Bottom Track

Model: KK-T72 - 1 Sliding Door+ 1 Fix
Material: Full SUS304 Stainless Steel
G.Thickness: 8mm Clear Tempered
Size: Custom Made



Model: KW-P51 Swing Door
Material: Full SUS304 Stainless Steel
G.Thickness: 8mm Clear Tempered
Size: 1200mm x 2000mm H
1400mm x 2000mm H



Model: KK-T41 - 2 Sliding Door + 2 Fix
Material: Full SUS304 Stainless Steel
G.Thickness: 8mm Clear Tempered
Size: 985 x 985 x 2000mm H



No Bottom Track

Model: KK-T111- 2 Panel Sliding Door
Material: Full SUS304 Stainless Steel
G.Thickness: 8mm Clear Tempered
Size: Custom Made



Model: RB180Z- Folding Door
Handle & Header: SUS304 Stainless Steel
G.Thickness: 8mm Clear Tempered
Size: Custom Made



Model: RB090R - 2 Panel Swing Door
Handle & Header: SUS304 Stainless Steel
G.Thickness: 8mm Clear Tempered
Size: Custom Made



Model: RB180 Swing Door
Material: Full SUS304 Stainless Steel
G.Thickness: 8mm Clear Tempered
Size: Custom Made



Model: RB090- 2 Panel Swing Door
Material: Full SUS304 Stainless Steel
G.Thickness: 8mm Clear Tempered
Size: Custom Made



Model: RS120- 2 Panel Sliding
Frame: Powder Coated (12 color choices)
Infill Panel: Polystrene/ Eco Panel/T.Glass
Size: Custom Made



Model: RS130- 2 Panel Sliding + 1 Fix
Frame: Powder Coated (12 color choices)
Infill Panel: Polystrene/ Eco Panel/T.Glass
Size: Custom Made



Model: RS130- 2 Panel Sliding + 1 Fix
Frame: Powder Coated (12 color choices)
Infill Panel: Polystrene/ Eco Panel/T.Glass
Size: Custom Made



Model: RS140- 2 Panel Sliding + 2 Fix
Frame: Powder Coated (12 color choices)
Infill Panel: Polystrene/ Eco Panel/T.Glass
Size: Custom Made



Model: RS-431 / 3 Panel Sliding + 1 Fix
Frame: Powder Coated (12 color choices)
Infill Panel: Polystrene/ Eco Panel/T.Glass
Size: Custom Made



Model: RS-220 / 2 Panel Sliding + 2 Fix
Frame: Powder Coated (12 color choices)
Infill Panel: Polystrene/ Eco Panel/T.Glass
Size: Custom Made



Model: RS-109 / 2 Panel Folding + 1 Fix
Frame: Powder Coated (12 color choices)
Infill Panel: Polystrene/ Eco Panel/T.Glass
Size: Custom Made



Model: RS-111 / 2 Panel Folding + 2 Fix
Frame: Powder Coated (12 color choices)
Infill Panel: Polystrene/ Eco Panel/T.Glass
Size: Custom Made